

Esquema de Montagem

Cristaleira Káki

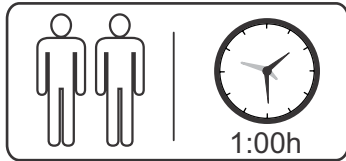

Peso Máximo Suportado
Distribuído

Ferragens

A		7 x 50	08	G		Cavilha Ø8 x 30	40	M		Rv8	18
B		Ø4,5 x 40	16	H		Haste Minifix	24	N		Cantoneira	04
C		M4 x 20	02	I		Tambor Minifix	24	O		Corrediça 300mm	01 Par
D		Kit Antitombamento	01	J		Chave Z	01	P		Dobradiça	08
E		3,0 x 16	24	K		Puxador	02	Q		Tapa Furo	08
F		3,5 x 14	80	L		Batente de Porta	04				

Componentes

N.	Componentes	Quant.
01	Tampo	01
02	Fundo	01
03	Lateral Direita	01
04	Lateral Esquerda	01
05	Prateleira	03
06	Travessa Corrediça	02
07	Travessa Frontal Interna	02
08	Rodapé Maior	02
09	Rodapé Menor	02
10	Pé Torneado	04
11	Traseiro Estreito	03
12	Traseiro Largo	01
13	Frente de Gaveta	01
14	Lat. Direita Gaveta	01
15	Lat. Esquerda Gaveta	01
16	Traseiro de Gaveta	01
17	Fundo De Gaveta	01
18	Porta	02



Forrar o chão com o papelão das embalagens para efetuar a montagem

Corrediças

Destrave a corrediça e retire a parte que será fixada na lateral ou na divisão (com cor mais escura).
A parte mais clara será colocada na gaveta e ilustrada na montagem das gavetas.

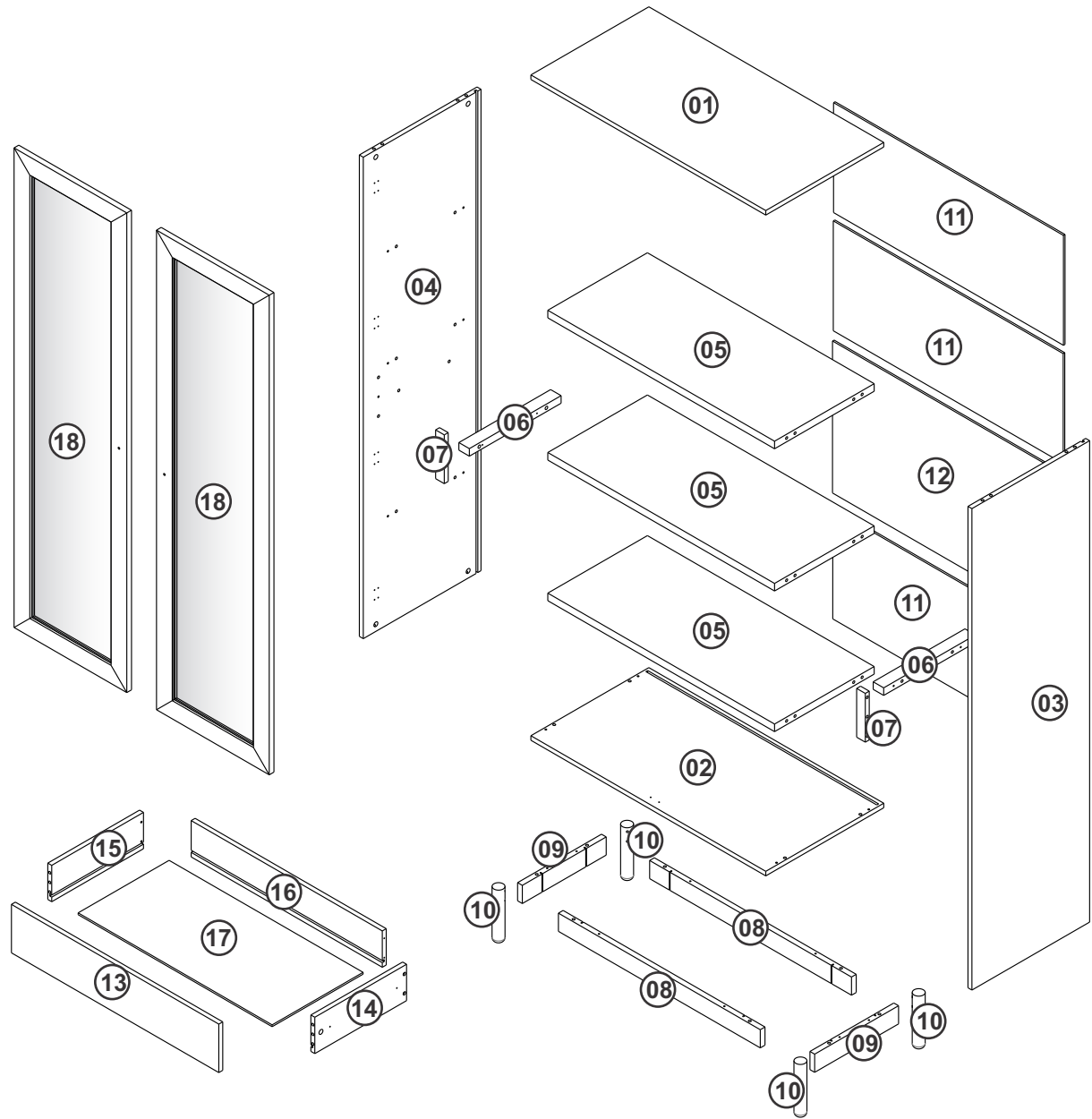
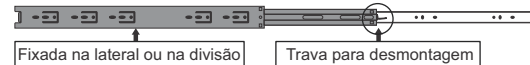

04

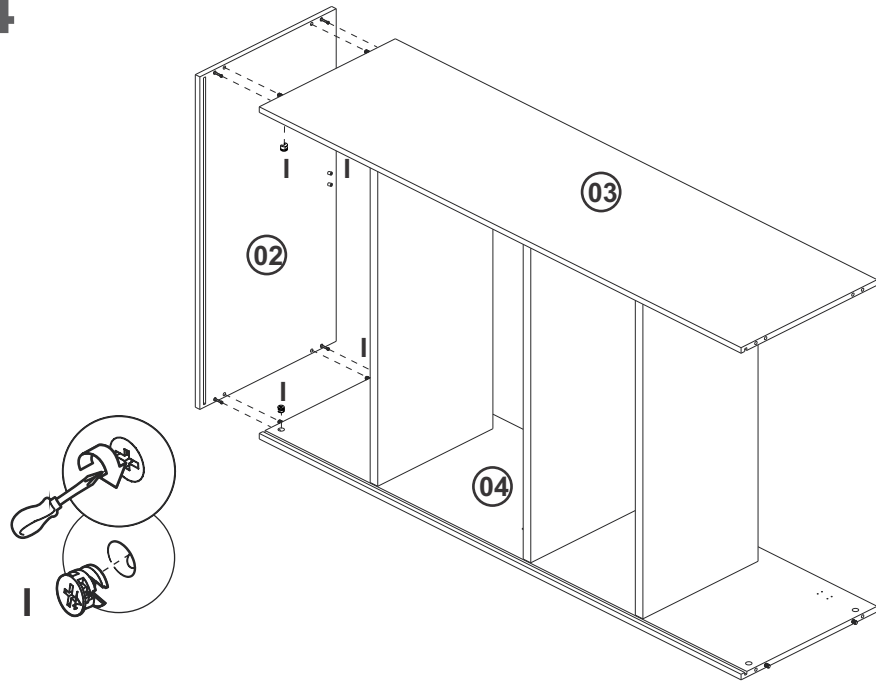

06

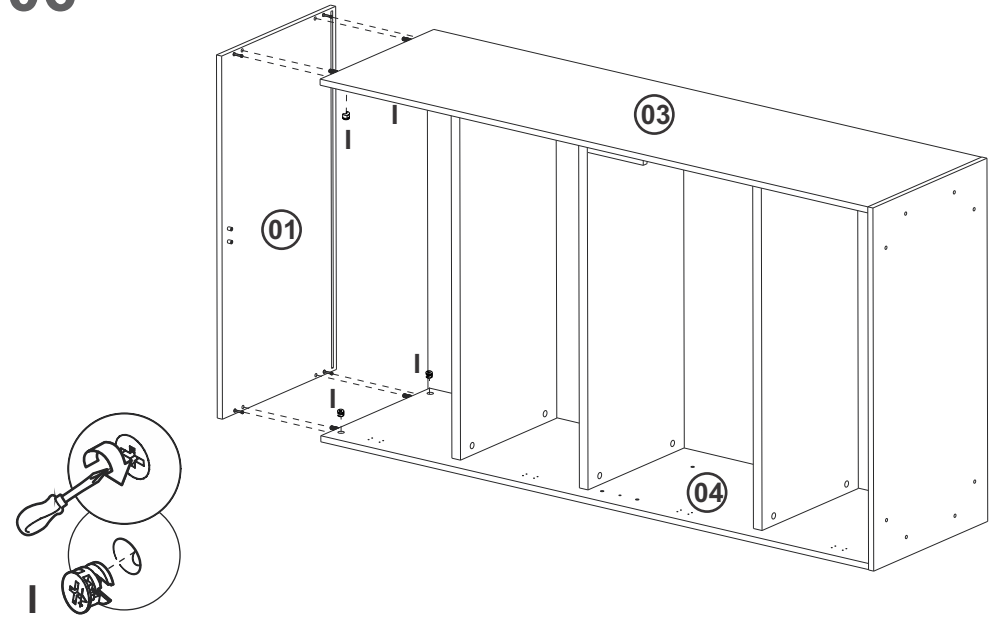

05

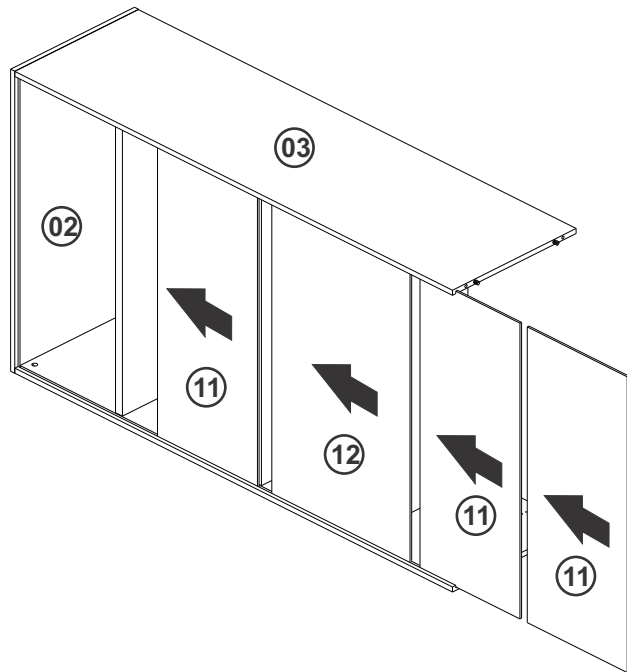

07

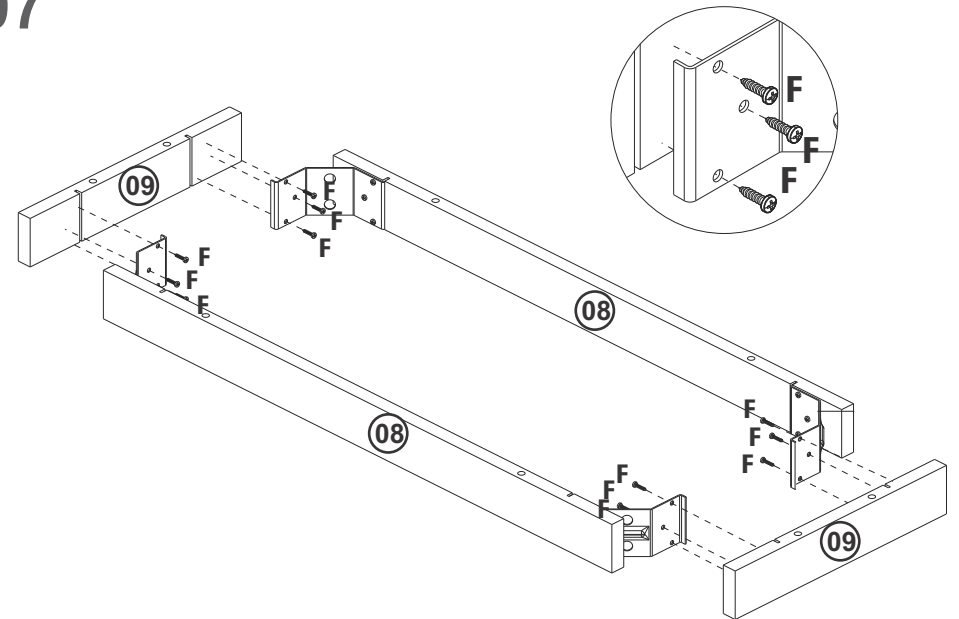

08

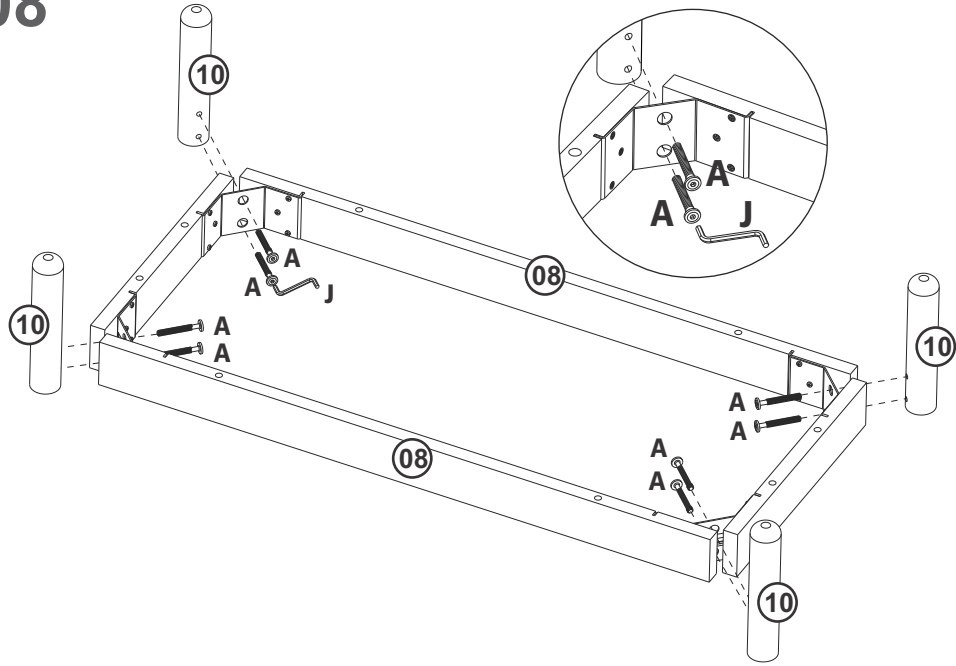

10

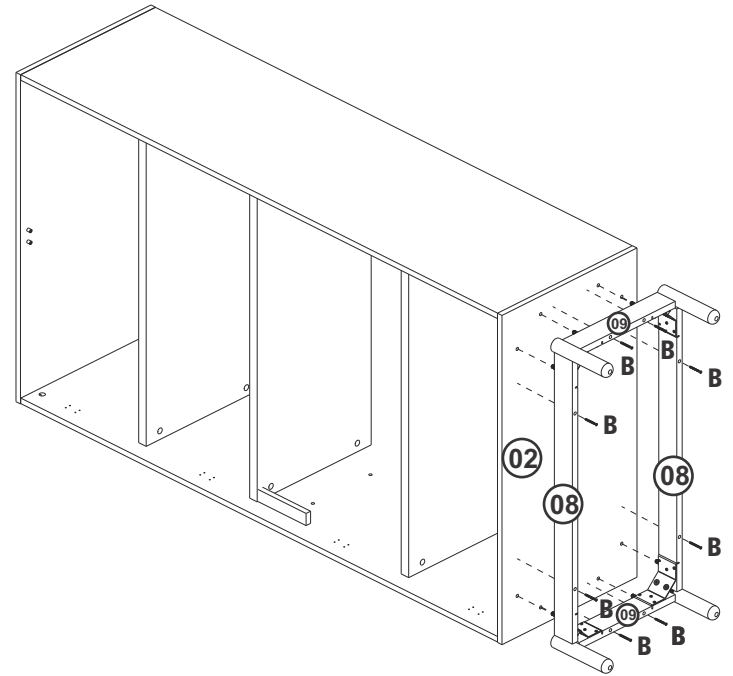

09

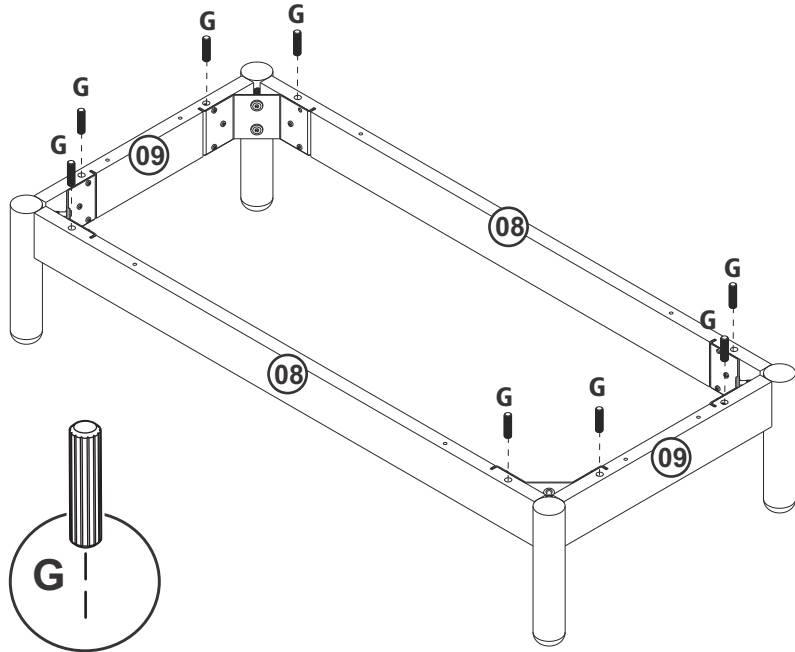

11

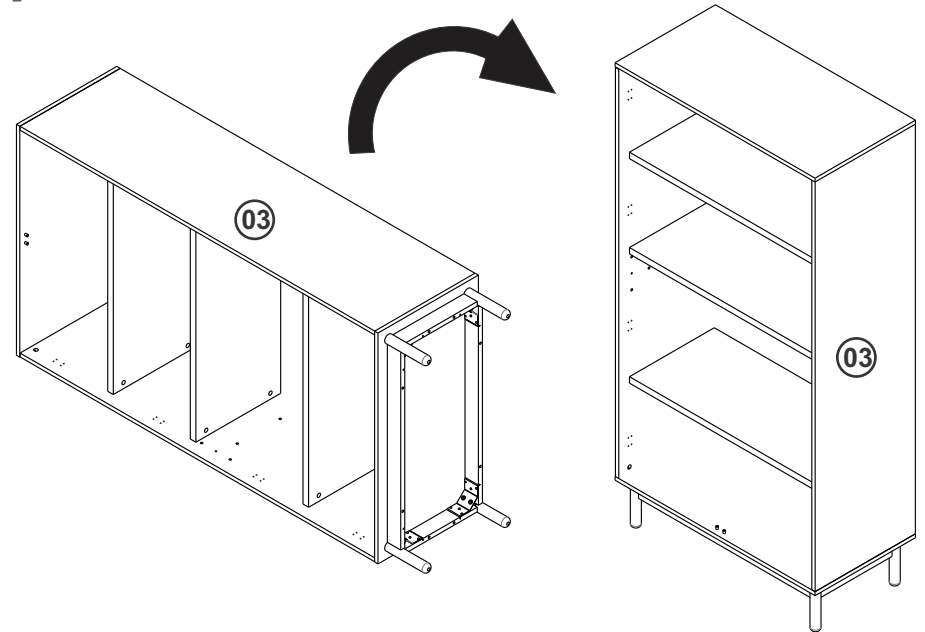

12

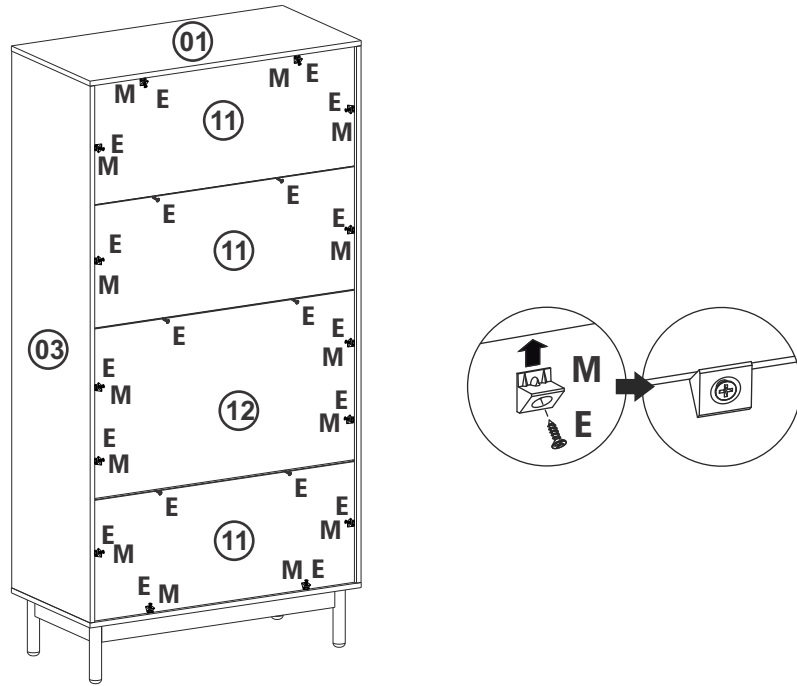

14

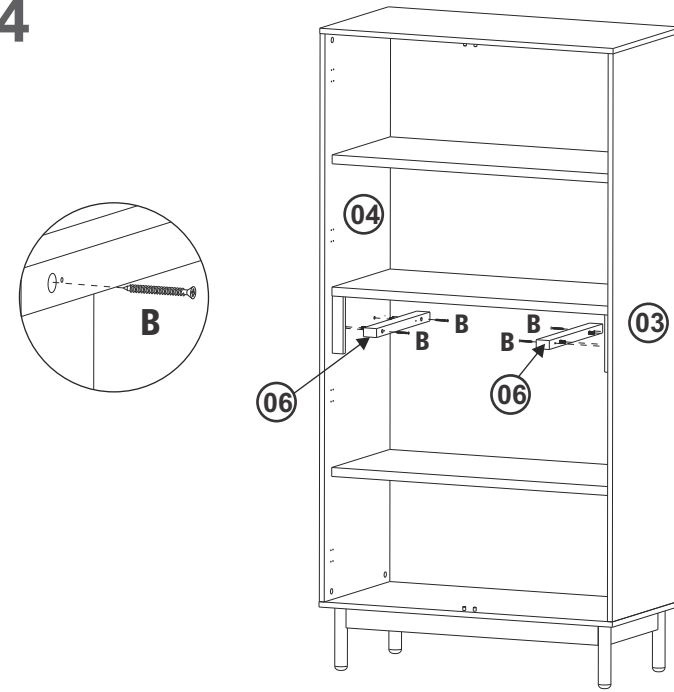

13

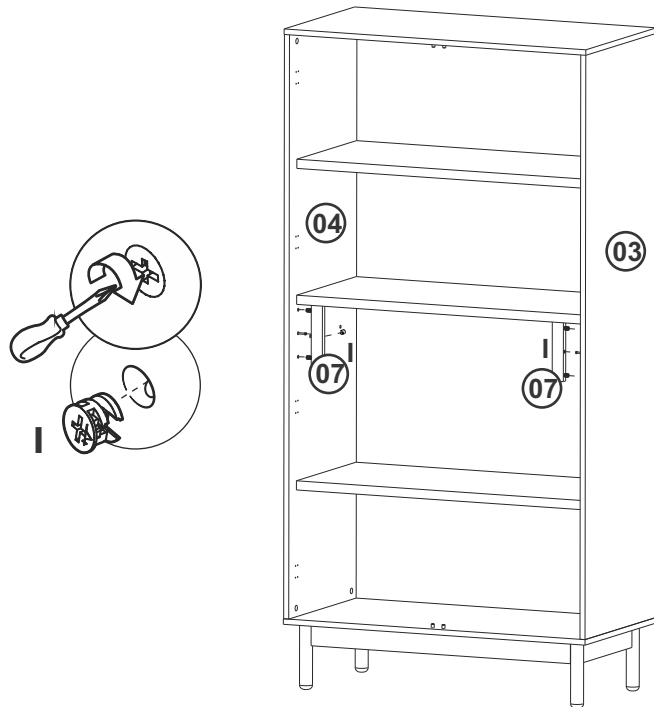

15

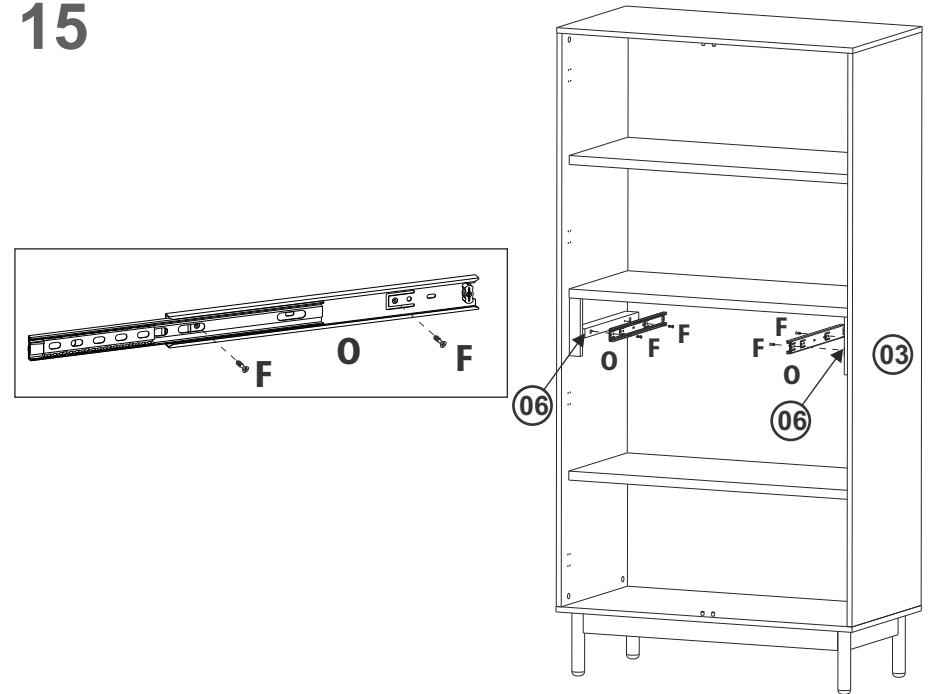

16

1°

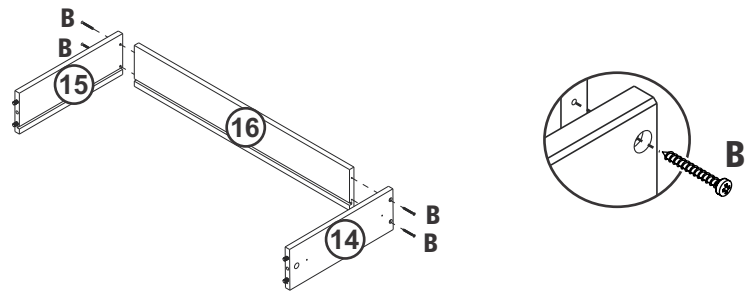

2°

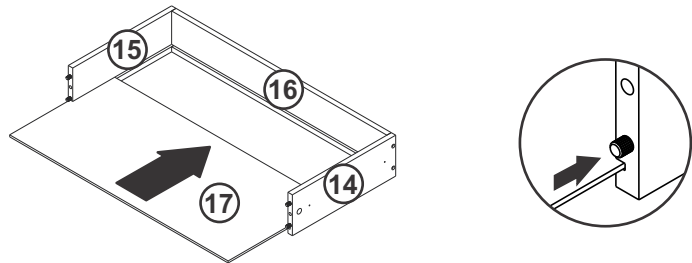

3°

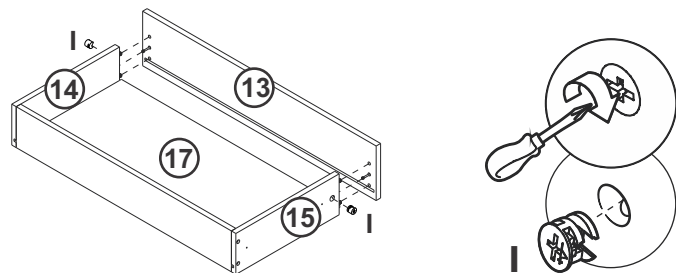

4°

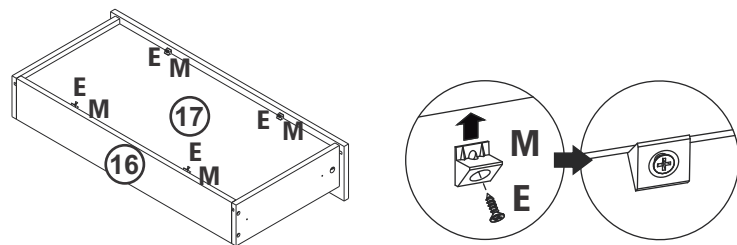

5°

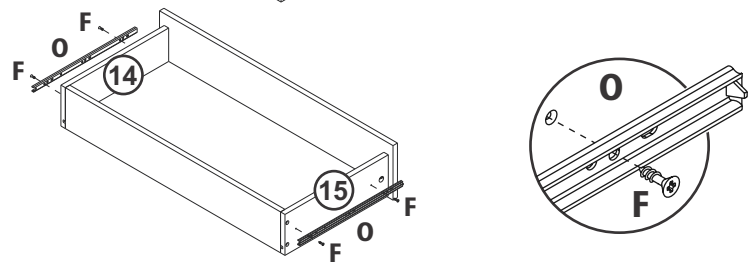

17

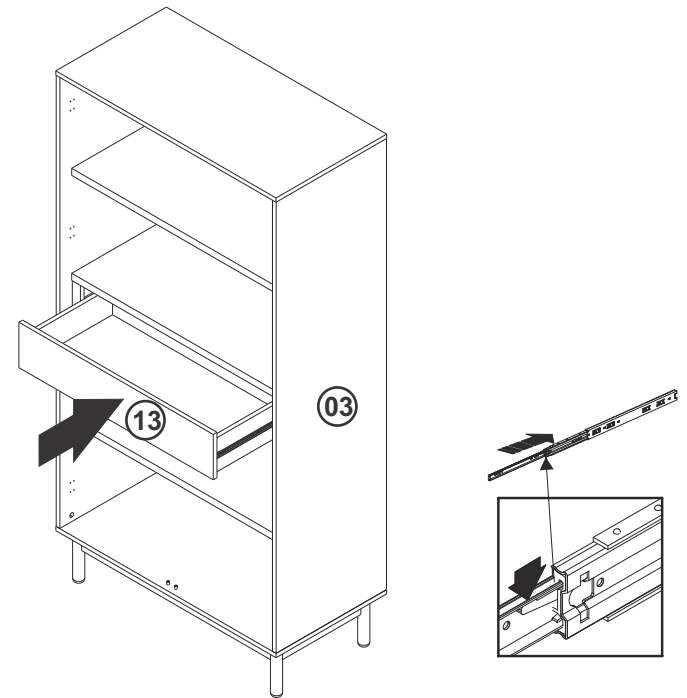

18 2x

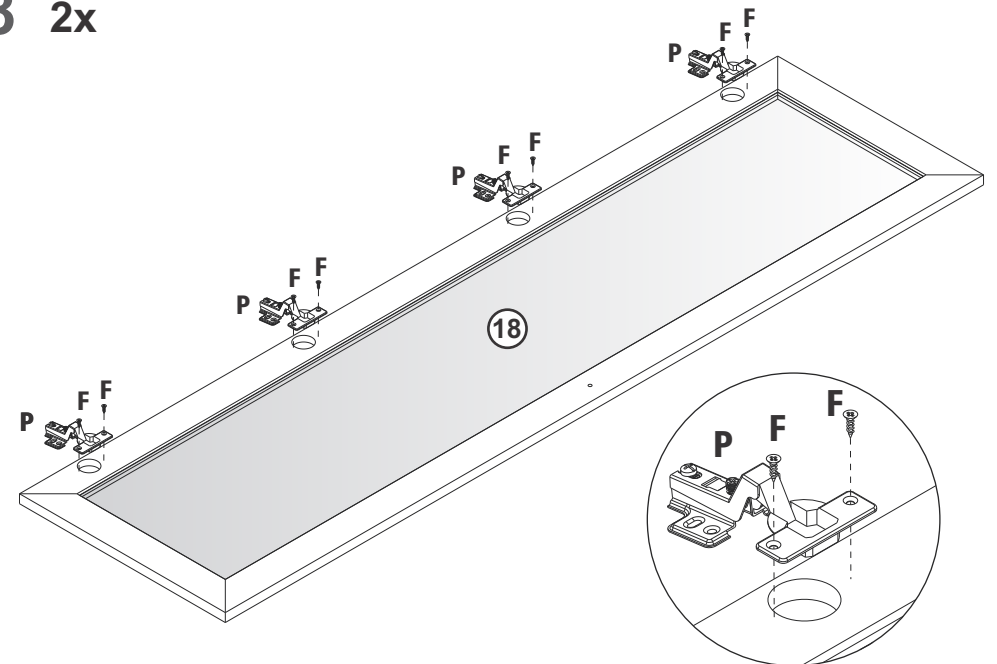

19

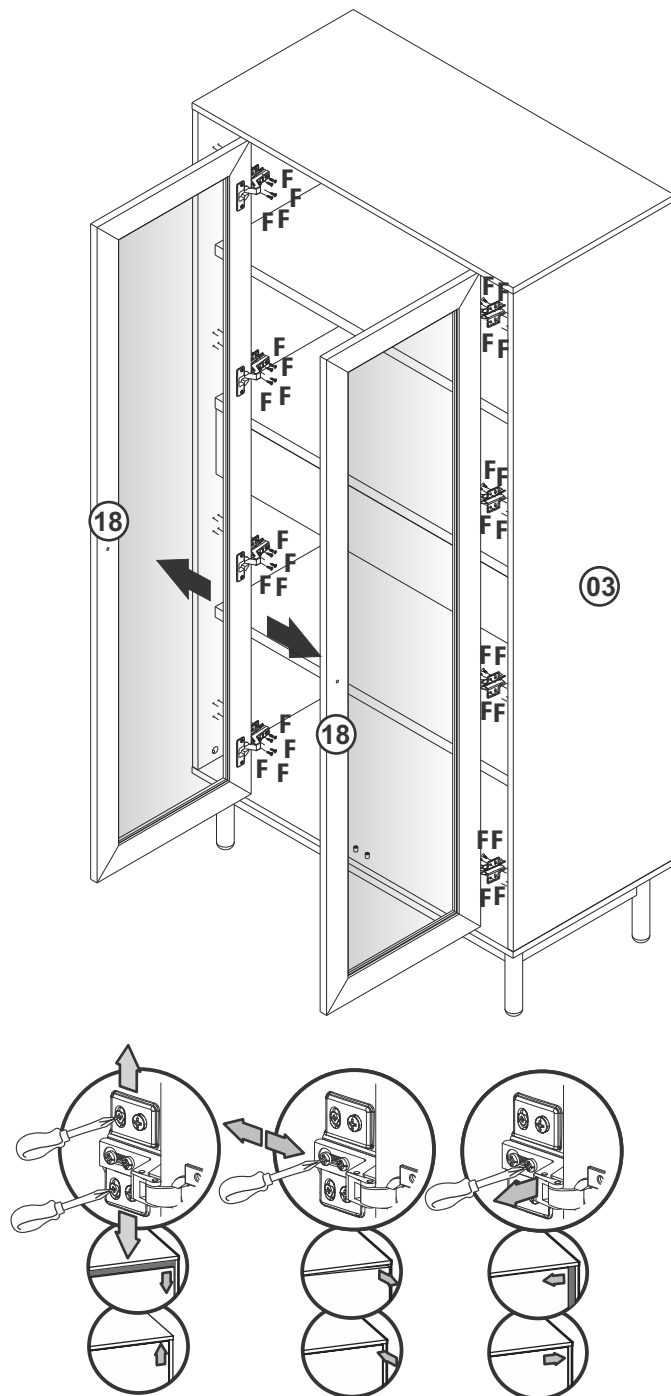

20

